



EN

**AIR PURIFIER**

**PURY BABY**



## **OPERATING INSTRUCTIONS**

Read the instructions carefully before operating or servicing the air purifier.  
Observe all the safety instructions; failure to observe the instructions may lead to accidents and/or damage. Store these instructions in a safe place for future reference.

## GENERAL OPERATING AND SAFETY INSTRUCTIONS

- **This appliance is a highly efficient air purifier designed for domestic use only!**
- Use this air purifier only as outlined in this manual. Any other use not recommended by the manufacturer may cause fire, electric shock or malfunctions.
- The unit must be placed in a vertical position at all times.
- Ensure that the available power source conforms to the required voltage and frequency (100 - 240V/50-60Hz).
- This appliance can be used by children aged from 8 years and above and people with reduced physical, sensory or mental capabilities or lack of experience and knowledge if they have been given supervision or instruction concerning use of the appliance in a safe way and understand the hazards involved.
- Children shall not play with the appliance.
- Cleaning and user maintenance shall not be made by children without supervision.
- Make sure that the plug is fully inserted. Do not use multiple adapters. Do not touch the plug with wet hands. Make sure that the plug is clean.
- This product is not a toy. Children should be adequately supervised to ensure that they do not play with the appliance.
- **Disconnect the main power when the appliance is not in use or during cleaning operations. Keeping the appliance plugged in may cause electric shocks or accidents.**
- To disconnect the appliance, set the switch to OFF and remove the plug from the socket. Pull on the plug only. Do not pull the cord.
- Do not bend, drag or twist the cord, or apply force to remove it. **Do not operate the unit if its cable or plug are damaged; doing so can cause fires or electric shock.** If the power cord is damaged, it must be replaced by a service centre.

- **Do not place heavy objects on the appliance.**
- **Do not use the appliance on unstable or sloping surfaces.**
- The air purifier must be placed **at least 50 cm** from the wall or from other obstacles, to ensure proper heat dissipation.
- **Close all open windows to maximise air purification efficiency.**
- **Do not insert objects or sharp instruments into the air outlet grille.**
- **Do not cover the air intake and outlet grilles in any way.**

**WARNING!**

**In the event of an anomaly, switch the appliance off and unplug it immediately. Do not dismantle, repair or modify this product freely. In the event of a malfunction, contact the after-sales service centre directly.**

- Do not immerse the power cord, plug or any other part of the appliance in water or other liquids.
- Do not expose the air purifier to direct sunlight.
- Keep the appliance well away from sources of heat which could cause plastic parts to become warped.
- Do not spray insecticides, oils or paints near the appliance; doing so may damage its plastic parts or start a fire.
- **Keep flammable gases and oils away from the appliance!**
- **Do not move the appliance while it is operating, as this may cause malfunctions.**

## DESCRIPTION OF PARTS

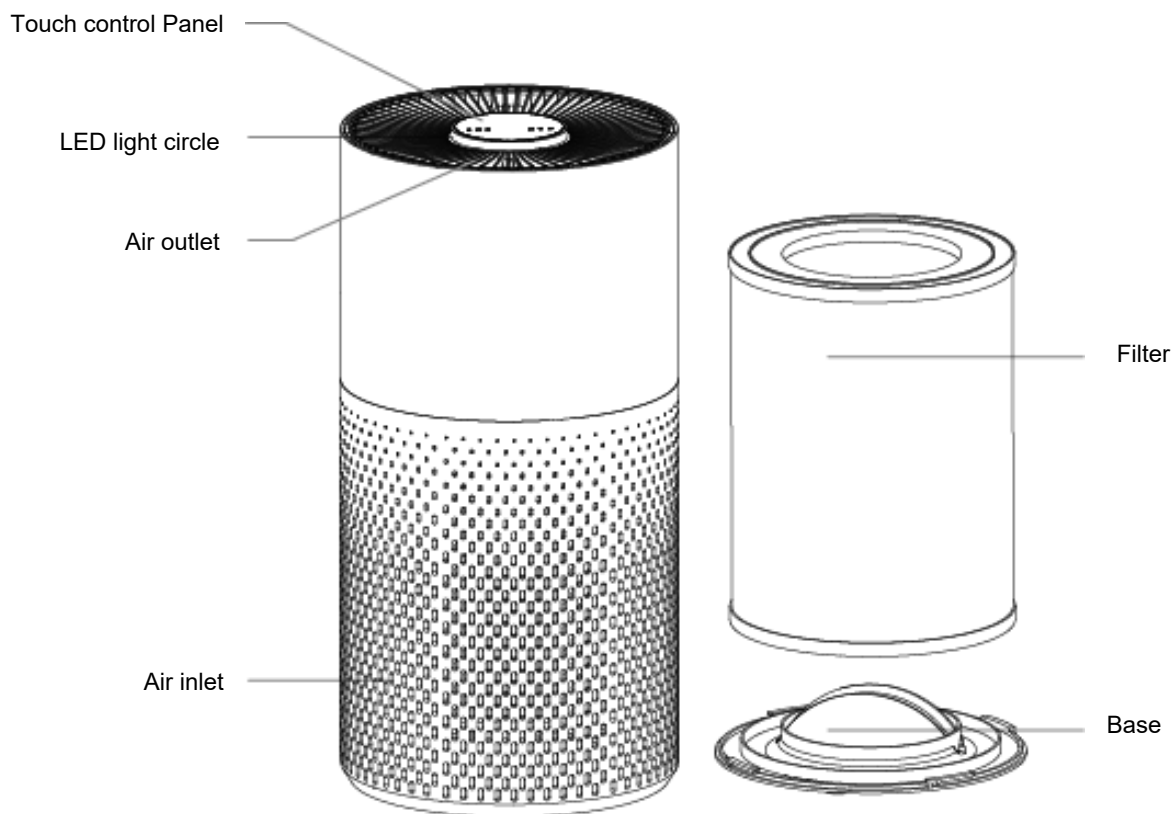

## OPERATIONS BEFORE USE

### FILTER INSTALLATION

Remove the plastic packaging of the filter before using for the first time, ensure the machine is unplugged before removing or installing the filter.

For the filter installation follow the next steps:

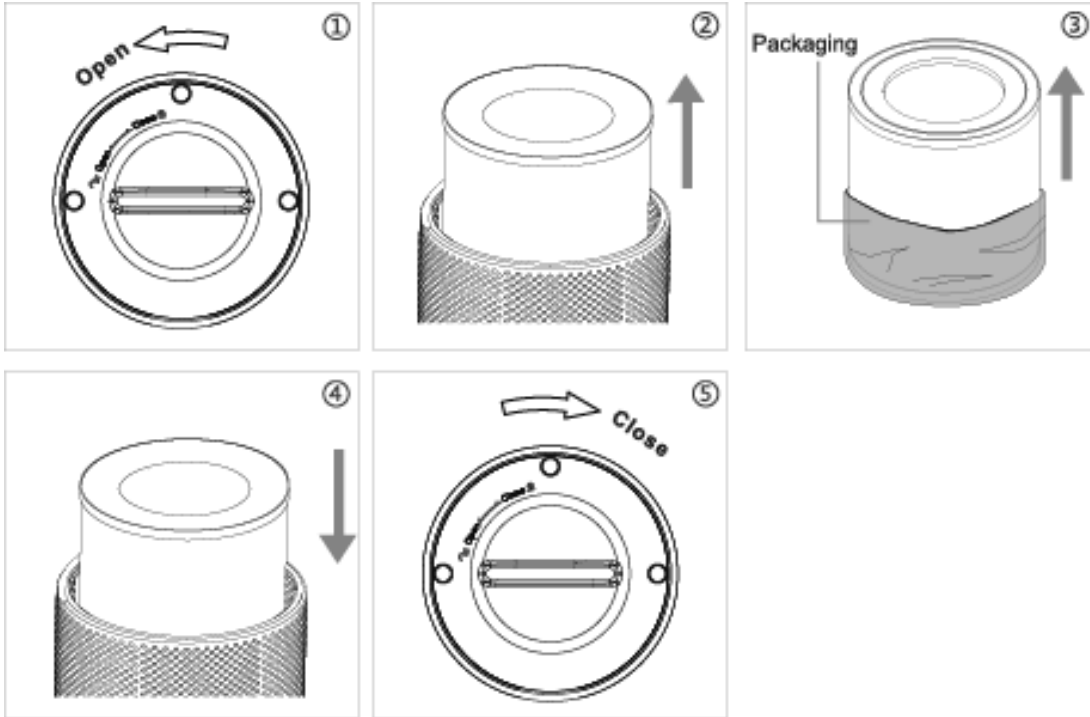

1. Invert the machine and rotate the base along the direction marked “OPEN”
2. Take out the filter from the machine
3. Remove the plastic packaging of the filter
4. Install the filter into the machine
5. Install the base, rotate and tighten the base along the direction marked “CLOSE”

Before use, ensure that the filter is correctly installed.

The filter is unique and made of:

- Pre-filter
- HEPA 11 certified filter
- Activated carbon filter

Particulate filtration efficiency: CADR 130 m<sup>3</sup>/h

When the lamp rings keep flashing in red, the filter should be replaced. Use only filter specially designed for this product.

Filter belongs to consumable items, which is not covered by the warranty.

## CONTROL PANEL



Power button



Timer button



Wind speed button



Light control button

### TURNING ON THE PRODUCT

When connect the appliance to the power socket, the buzzer will ring for 1 second, LED lights on the control panel and on the light circle will flash for 1 second, then go off.

#### POWER BUTTON



Touch the Power button to turn on or turn off the appliance.

To turn on the purifier touch the button Power, the buzzer will ring for 1 second to indicate that machine it's on, the default setting is medium wind speed (MID) and the corresponding LED indicator will be on.

To turn off the purifier touch Power button, the buzzer will ring for 1 second and all lights on control panel will be off.

#### WIND SPEED BUTTON



In the condition of working, touch the wind speed button, the buzzer will ring for one time, press again to adjust the desired wind speed among the circulation: SLEEP (low) -> MID (medium) -> HIGH mode with buzzer rings, the corresponding LED indicators will be on.

In SLEEP mode the corresponding LED indicator will be on for 3 seconds, then go off, lights on control panels and light circle will be off while the purificator will continue to work in low wind speed (SLEEP). Press any button on control panel to wake up the light.

#### TIMER BUTTON



In the condition of working, press the Timer button to set among the circulation (in hours): 2H -> 4H -> 8H -> OFF with buzzer rings, and the corresponding LED indicator will be on. Press again Timer button, the Timer indicator will be off and the machine will work continuously without Timer.

After setting the desired switch off time, when the time is up, the purifier will stop to work and lights on control panel will be off. Touch Timer button and the lights on control panel and on light circle will be on for 3 seconds, then turn off, touch any button on control panel to wake up the light.

## LIGHT CONTROL BUTTON

Touch the light control button and the light circle will be on and will automatically cycle the color between: blue – cyan – green – yellow – orange – red – purple. To hold the desired color press again the light control button. To deactivate the light circle press again this button, a buzzer will ring.

## CLEANING AND MAINTENANCE

### **Warning**

**Always pull the air purifier's plug out of the power socket before cleaning it, to prevent electric shocks or malfunctions.**

### **Warning**

**Do not wet or immerse the air purifier in water, as this may cause electric shocks.**

**Use a damp and soft cloth to clean the outer surface of the air purifier.**

**Do not use solvents, petrol, xylene, talcum powder or brushes to clean the unit: these may damage the surface or colour of the casing.**

### **Cleaning the casing**

Use a damp and soft cloth to clean the outer surface of the appliance.

Do not use excessively hot water, solvents, petrol or other aggressive chemical compounds, talcum powder or brushes: these may damage the surface or colour of the casing.

Remove stains using lukewarm water with a little neutral detergent.

Do not pour water onto the air purifier to clean it, as this may damage the internal components or cause a short circuit.

Do not drop any water into machine when clean the air outlet.

### **Cleaning the filter**

Clean the filter regularly. Do not wash the filter with water, do not use the vacuum cleaner, just gently clean the filter with a dry cloth. Sterilize the filter under sunlight regularly.

### **Replacing the filter**

When the lamp rings keeps flashing in red, the filter should be replaced. Contact a service center.

## **STORAGE**

Ensure the machine is power off and unplugged, gently use a soft cloth and neutral cleanser to clean away any dust or debris from the surface of the machine and air inlet/outlet. After the machine is completely dry, put it on a plastic bag and place it in a cool and well-ventilated place.

If the appliance has not be not used for long time, turn on the machine for few minutes from time to time to ensure good performance.

## TROUBLESHOOTING

SITUATION	POSSIBLE REASON
No working	<p>Power cord could be not plugged into a power socket</p> <p>The power outage could be not adequate, check the data on rating label</p> <p>There could be a home leakage switch or fuse cut off</p> <p>Filter indicator keep flashing in red, it means that filter need to be replaced</p>
Poor performance	<p>On surface or pre-filter there could be dust</p> <p>There could be any obstacle blocking the air inlet/outlet</p>
Significant noise	<p>There could be a stuck on the fan in the air outlet</p> <p>The machine is tilted</p> <p>Set a lower grade of wind speed if the noise is too loud or set SLEEP wind speed when using the appliance in the bedroom at night</p>
Coming out a nasty smell	<p>It is a normal phenomenon that the machine emits the smell of plastic for the first time</p> <p>The machine will emit a nasty smell if the filter is dusty, so in this situation clean or replace the filter</p> <p>If the machine will emit a burning smell, unplug the power socket and contact a service center</p>
The reminder of replacing filter is still flashing after user has replaced with a new one	<p>Press Power button for 7 seconds to reset the machine</p>





**INFORMATION ON CORRECT DISPOSAL OF THE PRODUCT ACCORDING TO EUROPEAN DIRECTIVE 2012/19/EU ON THE DISPOSAL OF ELECTRICAL AND ELECTRONIC WASTE MATERIALS'**

This appliance must not be scrapped with domestic waste at the end of its life cycle. We call your attention to the crucial role played by the consumer in the reuse, recycling and other forms of recovery of such waste.

The dismantled appliance, with its components collected separately, must be delivered to the local waste disposal facility or returned to the dealer free of charge when purchasing a new equivalent appliance.

Sorted disposal of electric and electronic equipment prevents potentially negative consequences on the environment and human health due to improper scrapping, and also allows the constituent materials to be recovered and recycled, with significant savings in terms of energy and resources.

The sorted disposal requirement is indicated by the crossed dustbin symbol affixed to the product.



improve your life

[www.argoclima.com](http://www.argoclima.com)